



Hacienda Creek

Why Choose Hacienda Creek?

Providing pleasant living environments for seniors has always been one of the key objectives for ROEM Development. This latest 80-unit senior apartment project not only alleviates some of the housing shortage here in the Bay Area, but also allows us to present to the greater community an exemplary senior housing design that can set new standards.

Pastoral, Private Location

The site is located at the terminus of two minor residential streets, adjacent to a public park and a creek. This beautiful, natural setting gives the senior residents the sense of comfort they have always pursued. To further enhance privacy and intimacy, we have arranged the 80 units in small clusters and wings. This helps to avoid the institutional feeling commonly found in large-scale housing projects.

Spacious, Elegant Interior

The building design also demonstrates our sensitivity in bringing light and view into the interior hallways and activity rooms. The experience of traveling within the building has been made more pleasurable, with convenient access to the park, the creek, and courtyards everywhere.

Graceful, California Mission Style Exterior

On the exterior, the project takes on a California Mission style of architecture. By incorporating details and articulating the rooflines, we have effectively brought down the building scale. We have also extended the wings of the building deep into the courtyards, allowing them to fully embrace the landscape.



408.885.0551

399 East Court, San Jose, CA 95116

Graceful Exterior

- ☼ Comfortable outdoor veranda with fireplace to meet and enjoy your friends, family and neighbors
- ☼ Community Center with kitchen for public enjoyment or private reservation
- ☼ Responsive on-site management and maintenance professionals
- ☼ A beautiful, gracefully lit water fountain welcomes you home
- ☼ Gentle valley breezes are accented by the whispering creek and mountains that decorate the background scenery

Elegant Interior

Sophisticated one bedroom apartment homes include:

- ☼ Expertly designed floor plan
- ☼ Rich honey-colored cabinetry
- ☼ Air conditioning
- ☼ Soaring 9' ceilings
- ☼ Double paned windows
- ☼ Plush carpeting
- ☼ Elevator
- ☼ Washer/dryers available on each floor
- ☼ Free on-site public use library
- ☼ Community center with fireplace
- ☼ Computer lab
- ☼ Activity van

Fully accessorized kitchens including:

- ☼ Microwave
- ☼ Disposal
- ☼ Large Refrigerator
- ☼ No-wax vinyl flooring

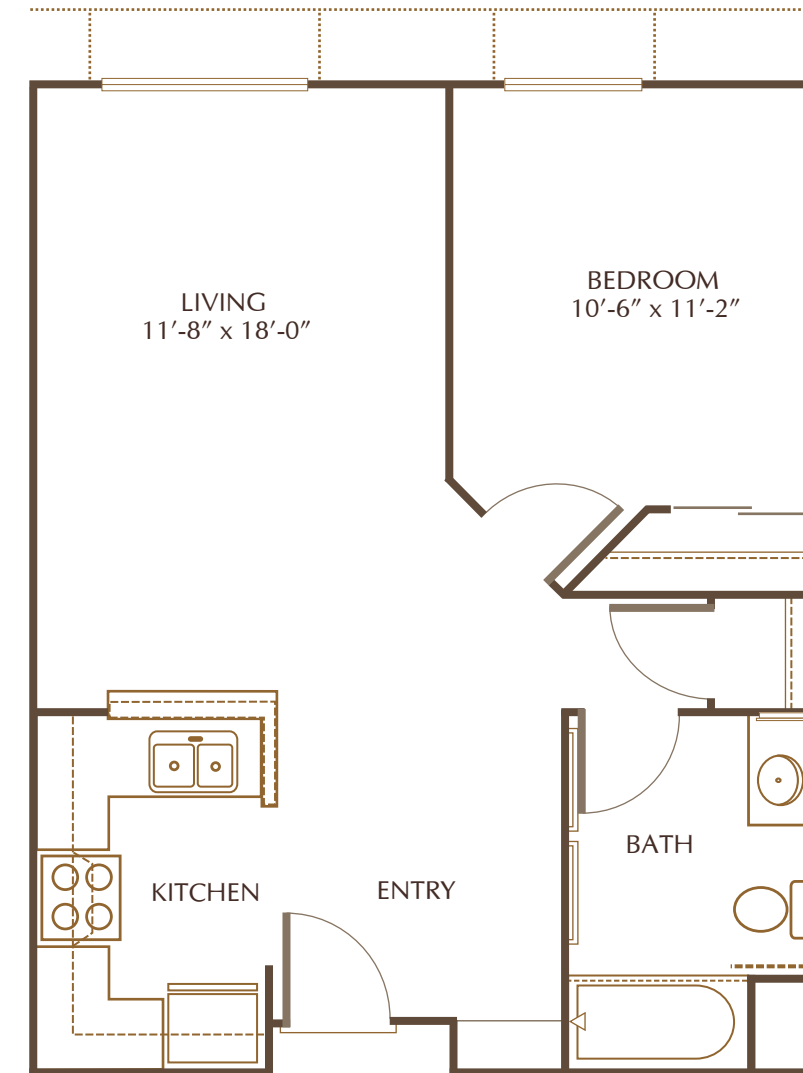

Floorplan A

1 Bedroom

1 Bath

Rent _____

Deposit _____

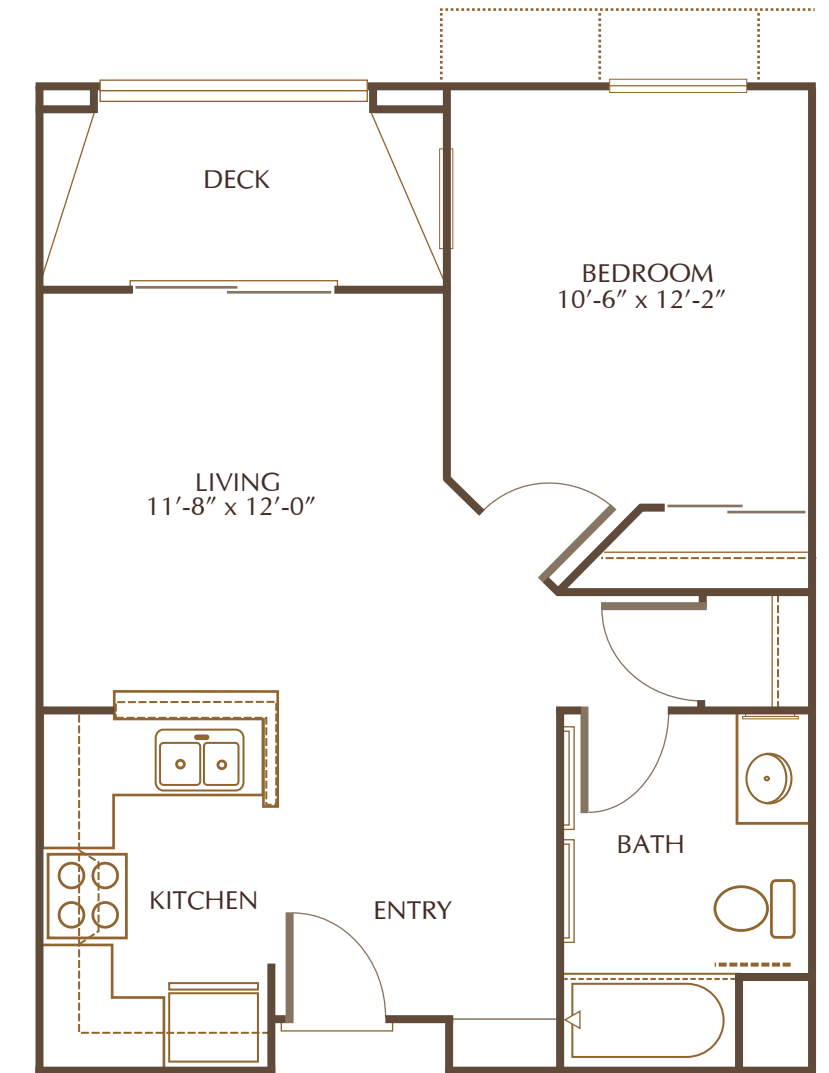

Floorplan B

1 Bedroom

1 Bath

Rent _____

Deposit _____

Site Map

- L - Laundry
- T - Trash
- E - Elevator



Location Map

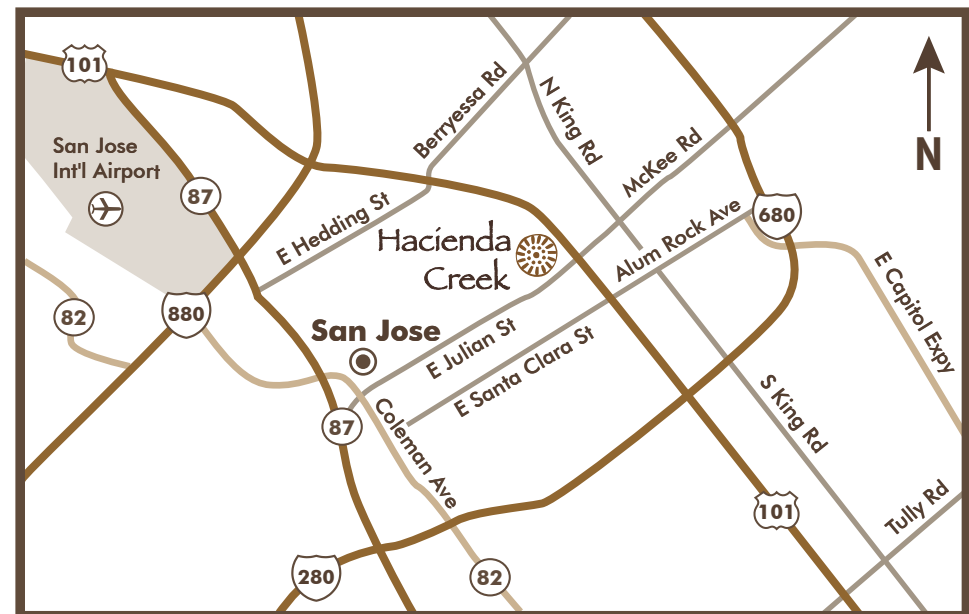

399 East Court, San Jose, CA 95116

From Interstate 680:

- Merge onto 101 North.
- Exit onto McKee Road/Julian Street
 - turn left at the light
- At the next light turn right onto 28th Avenue
 - turn left onto West Court
 - the street ends at Hacienda Creek

From Interstate 880:

- Merge onto 101 South.
- Exit onto McKee Road/Julian Street
 - turn right at the light
- At the first light turn right on 28th Avenue
 - turn left onto West Court
 - the street ends at Hacienda Creek

ROEM
CORPORATION